

## 1 Gneuss Insert Bush Adaptors

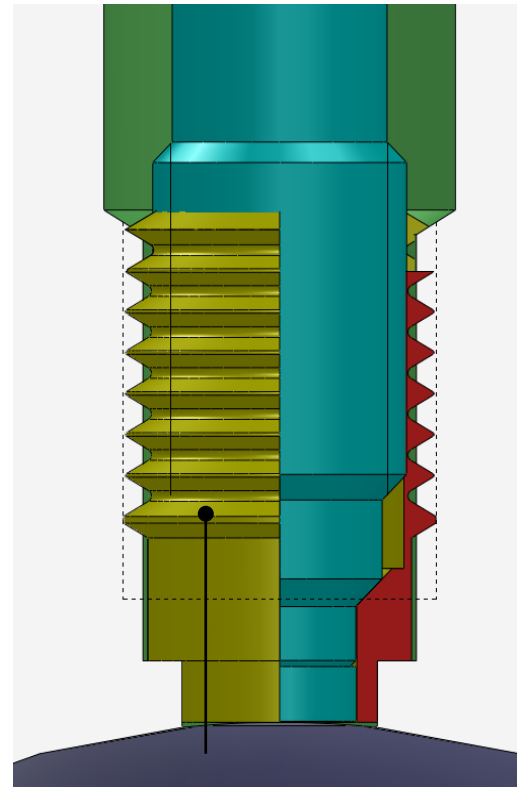

The insert bush adaptor for the installation of measurement sensors (DGBM 82 222 328) facilitates and simplifies the installation of measurement sensors and helps to reduce costs. There is no need for special tools, a standard thread-cutting tool M24 or M16 is sufficient to make the drillings.



Insert bush adaptor

### Advantages:

- Precision made, with hardened surfaces. Designed to avoid damage to the sensor tip and membrane.
- A seizure of the thread, leading to a destruction of the sensor, is practically avoided.
- Damage to the pressure transducer drilling means that only the insert bush needs to be replaced.
- The reduction bush allows the introduction of a sensor with  $\frac{1}{2}$ "20UNF-2A thread in an existing sensor drilling with M18 x 1,5 thread.

### Insert Bush Adapters

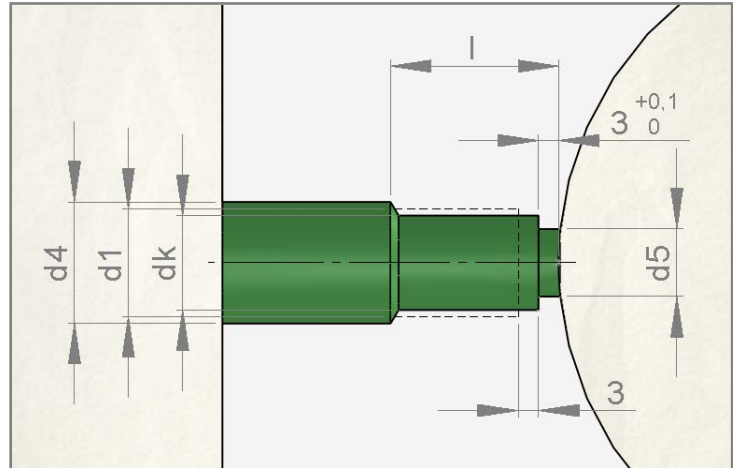
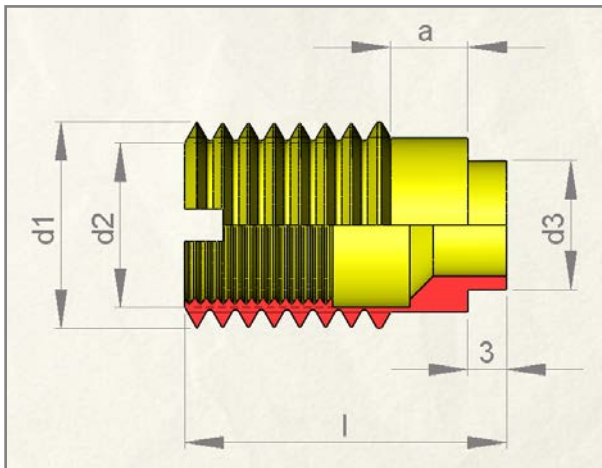

d1	d2	d3	d4	d5	a	l	dk
M24	M18 x 1,5	Ø13,95- 0,05	Ø26	Ø14 <sup>H7</sup>	10	35	Ø21
M16	½"-20 UNF	Ø9,95- 0,05	Ø18	Ø10 <sup>H7</sup>	6	25	Ø14

## How to install the Insert Bush Adaptor:

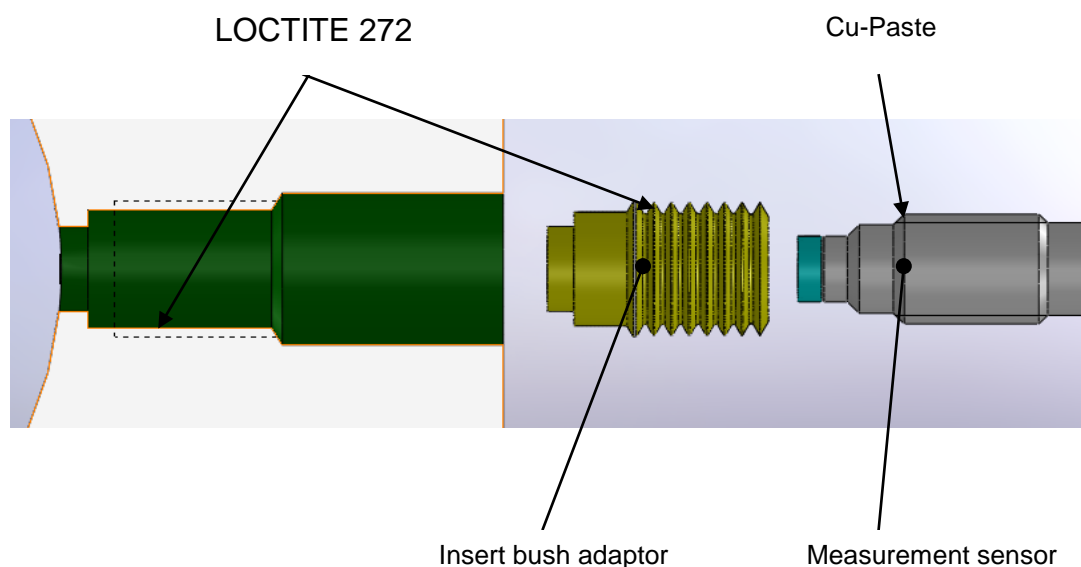

Surfaces to be covered with adhesive are to be cleaned with a suitable detergent!

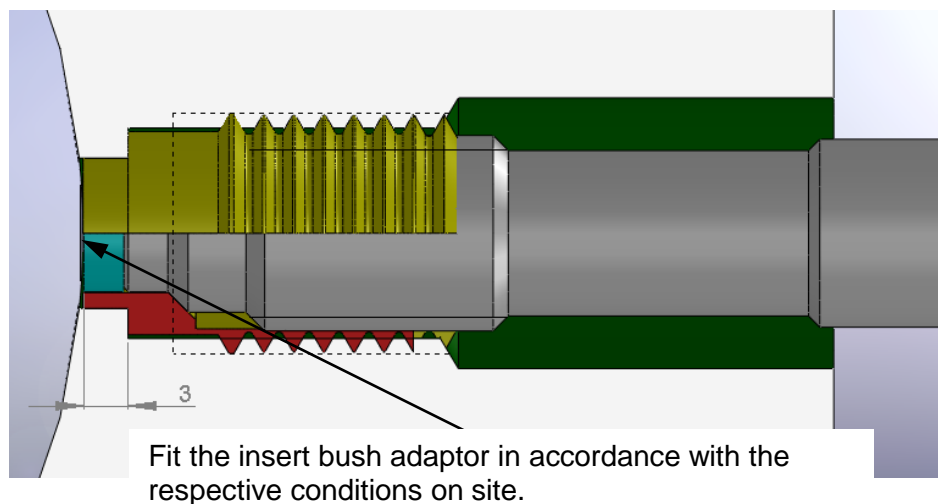

Do not rework!

Torque for insert bush adaptor		Torque for measurement sensors	
M16 – ½" – 20 UNF-2A	<b>max. 35 Nm</b>	½" – 20 UNF-2A	<b>max. 35 Nm</b>
M24 – M18 x 1,5	<b>max. 100 Nm</b>	M18 x 1,5	<b>max. 50 Nm</b>

### Copyright notice acc. to ISO 16016

The reproduction, distribution and utilization of this document as well as the communication of its contents to others without express authorization is prohibited. Offenders will be held liable for the payment of damages. All rights reserved in the event of the grant of a patent, utility model or design.

Gneuss Kunststofftechnik GmbH  
Moenichhusen 42  
32549 Bad Oeynhausen, Germany  
Phone: +49 (0) 5731 5307-0  
Fax: +49 (0) 5731 5307-77  
Mail: [gneuss@gneuss.com](mailto:gneuss@gneuss.com)  
[www.gneuss.de](http://www.gneuss.de)